

APPLICATIONS

The series HSSPLJ Single Point Lifting Jib is a general purpose attachment designed to slip on and clamp to the fork tynes. This slip-on Forklift attachment is supplied standard with a safety mounting chain to secure the jib to the forklift truck along with a safety swivel hook and shackle.

The standard finish on this attachment is safety yellow paint.

SPECIFICATIONS

Model No	HSSPLJ-20
SWL	2000kg
H C of G	150mm
V C of G	160mm
Weight	28kg
Fork Pockets	125x50mm
Pocket Centres	450mm
Design	HSRD 123

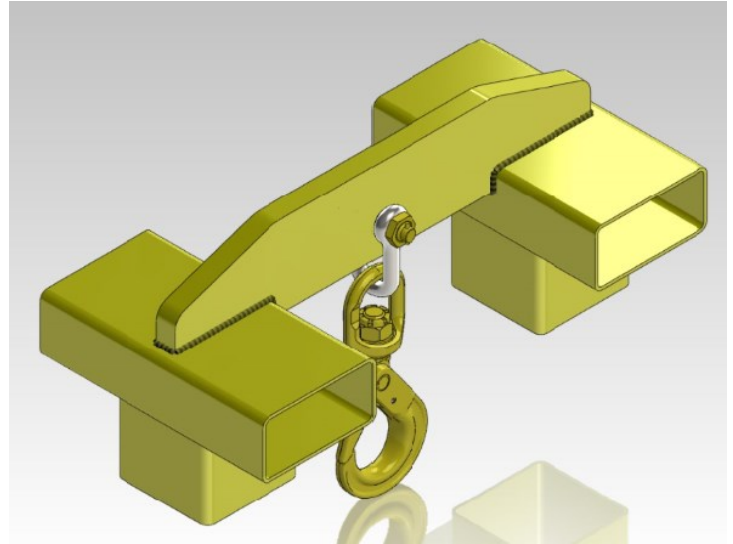

Note: All lift truck attachments affect the safe working load of a lift truck. In the case of a slung load when lifting a jib attachment, the net lifting capacity should be 0.8 times the rating of the lift truck to allow for the swinging load. End users should consult their lift truck supplier to ensure the lift truck is rated for use with these attachments.

