

**SPECIFICATIONS**

WLL:	2800kgs
Load Centre:	1497mm
H C of G	994mm
V C of G	0mm
Weight:	254kg

**NOTES**

- To suit fork max 150x65mm.
- As per AS2359.1.
- Safety yellow painted finish.
- Secured to truck via locking pin plates.
- Grind sharp edges.
- Design HSRD 2145.

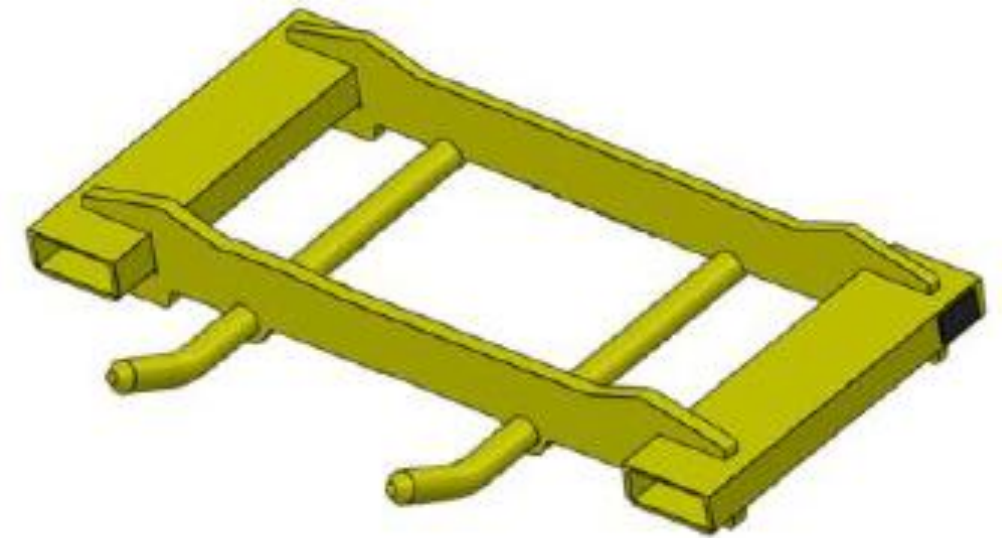
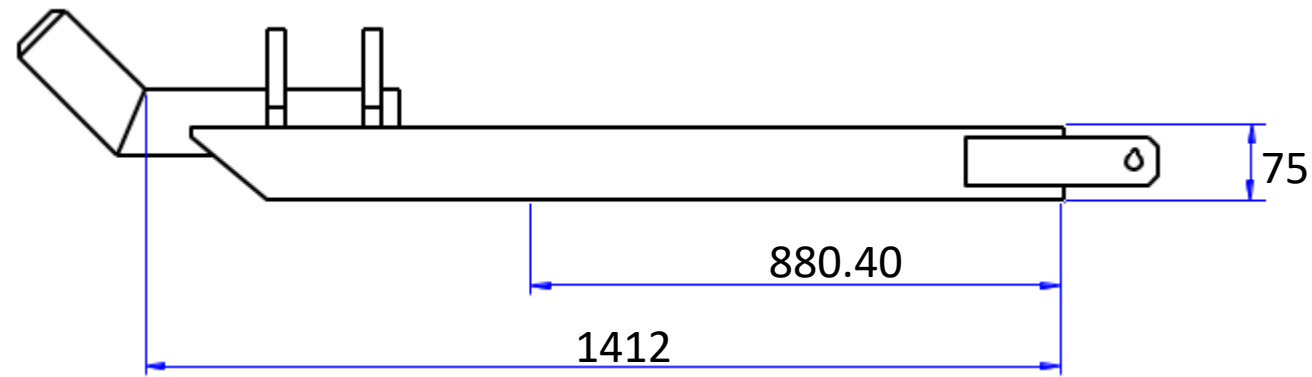
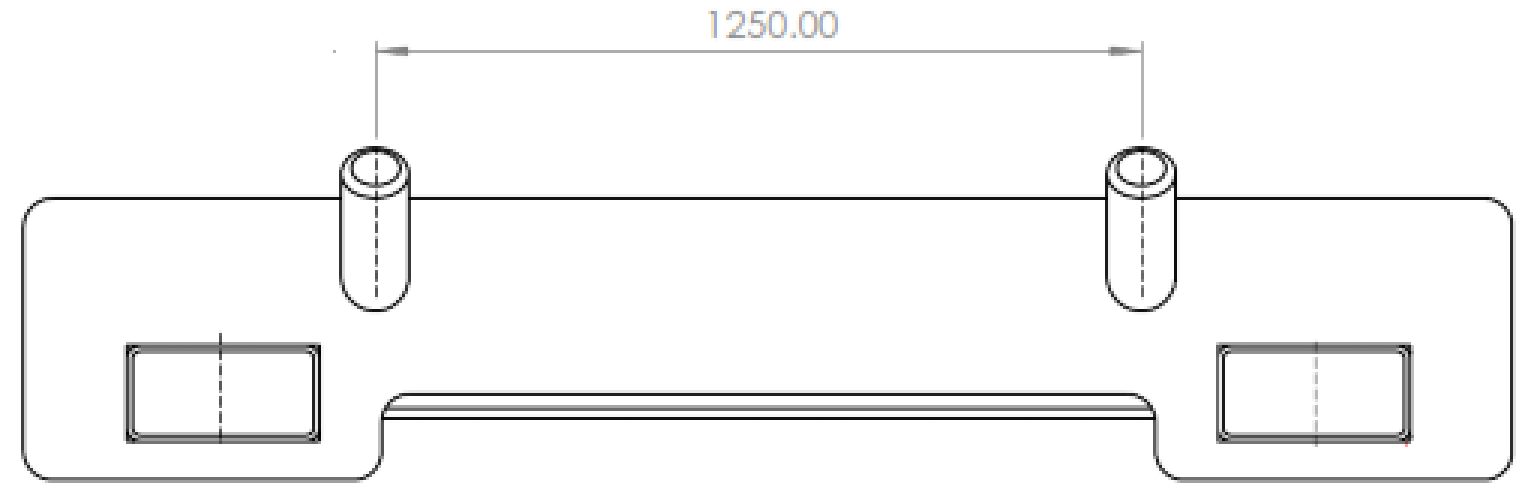

	MM		<b>HS RESEARCH &amp; DEVELOPMENT PTY LTD</b> 2/3 ATLAS COURT, WELSHPOOL WA 6106 Ph: +61 (08) 9458 7933 F: +61 (08) 9458 1351	
	D.N.S		<b>HSBBJ-RH Dual Bulk Bag Jib – Rhino Horn</b>	
	CHECKED	DRAWING STATUS FOR QUOTING PURPOSES		<b>HSRD 2145</b>
		SCALE: DO NOT SCALE	DIMENSIONS IN MILLIMETRES	DO NOT SCALE